

Mr. Dewey and Friends

Newsletter of the Friends of the Guelph Public Library

A New Main Library and a Vibrant New Downtown Core

With one, far-reaching decision, on February 17, the majority of Guelph City Council members demonstrated that their vision is long range, their focus is quality of life in Guelph, and they understand that excellent cultural facilities are of long term economic benefit; attracting desirable businesses and high-achieving citizens to the city.

As a full gallery of concerned citizens looked on, Council approved the conceptual design recommended to them by City staff, for a new main library and the redevelopment of Baker Street. Included is a 90,000-square-foot main library on three floors and about 400 public parking spaces. The plan is to seek private development of 200 to 300 residential units and about 20,000 square feet of commercial space as part of the same initiative. After nine years of engineering studies and consultants' reports, this decision lays the groundwork, finally, to replace a main library building that is so inadequate it is an embarrassment.

Four buildings facing onto Wyndham St., north of the former Post Office building, will be expropriated to facilitate this development. The City has made a commitment to help displaced businesses find suitable new locations, and City staff have been asked to provide a plan to address the loss of low-cost housing in the expropriated buildings.

In addition to allowing the building of a main library worthy of a University city projected to grow to more than 150,000 citizens in the near future, this project will be a huge asset in the redevelopment of a decaying area of the downtown core. This is the kind of planning and development that happens in municipalities with visionary leadership; municipalities that emerge as outstanding examples of quality urban life and architecture.

The role of Friends (and friends) of the Library in this development is to understand the issues and clarify them, when the opportunity presents itself, for those who continue not to understand its benefits to the City.

- Several engineering studies over a ten year period have clearly and definitely eliminated expansion on the current library site as an option to address the need for improved library space.
- More branches will not address the need. Branches are popular reading depots with no admin-

istrative space. Administration, ordering, cataloguing, automated system development and support, archival and rare collections, in-depth research information and specialized professional assistance of all kinds reside only in the main library. To suggest that any of these should be replicated in multiple branches is to support an infinitely more expensive administrative model than the one presently in place.

- Countless studies show that library use increases in difficult economic times. Despite a woefully inadequate main building, the Guelph Public Library already boasts the largest membership per capita in the province, and one of the highest rates of use. It is difficult to imagine a more appropriate target for improvement or a more appropriate anchor for urban redevelopment. Locating the Library as is now planned will bring hundreds of thousands of additional visitors into the downtown core each year.

The Friends of the Guelph Public Library applaud this landmark decision and anticipate the next steps with enthusiasm.

Virginia Gillham
Chair, Friends of the Guelph Public Library

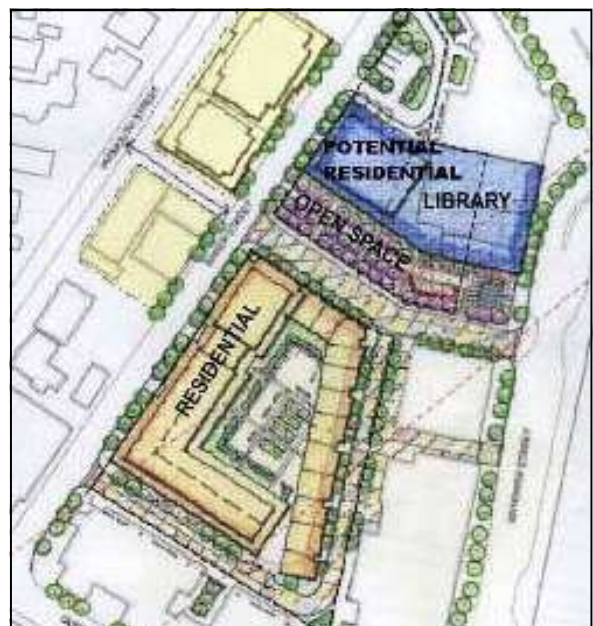

Friends of the Guelph Public Library

Executive

Virginia Gillham, Chair

Secretary

Alan Pickersgill, Treasurer

Mary Mulholland, Advocacy

Graham Smith, Membership

Members at Large

Marjorie Bethune

Liz Macrae

Ian Robson

Ex-Officio Members

Norman McLeod,

Chief Librarian

Kerry Hannah,

Children's Services

Alan Pickersgill,

Library Board

Newsletter Editors

Marilyn Crooks

Susan Ratcliffe

The Executive welcomes your comments and suggestions. Members may be contacted individually; written submissions may be left with Circulation staff at any library branch.

Is Your Membership Up-to-Date?

Membership renewals are now due. Renewals and new memberships are valid through April 30, 2010.

See Page 6 for a membership form. Completed forms addressed to The Friends of the GPL may be left at the Circulation Desk of any branch.

Your Library— Even More Important Today

Did you know? Library use increases in periods of recession. In times of economic difficulties people turn to their libraries - the only place people of all ages and all circumstances can find and freely access a diversity of resources, along with the expert guid-

Mark Your Calendar for April 15th

The Annual General Meeting of the Friends will take place on Wednesday, April 15, at 7:30 p.m. on the second floor of the main library. The agenda will include a summary of the activities of the Friends over the past year and an update of the library's current situation, including the latest information on the planning for a new main library building. As has become the custom, an honorary member will be recognized who has shown outstanding support of the library.

The Executive for the coming year will be elected at this meeting. All of the current Executive members have indicated their willingness to stand for re-election; however there are presently two Executive vacancies. Both a secretary and a coordinator of special events are needed urgently. If you are interested in becoming more involved with the activities of the group, and feel you could assume one of these responsibilities, please contact Virginia Gillham virginiagillham@aol.com, (519-821-5874) or Liz Macrae (519-824-5014).

The highlight of this evening will be remarks from well-known local historian Gil Stelter, whose theme will be the relationship of the architecture of cultural places and a city's concept of itself. Gil will talk about the River Run Centre, the convent/museum, the City Hall and the forthcoming new main library, and the relationship of these buildings to the cultural self-awareness of Guelph.

Don't miss this evening. It will be of significant interest to the library's many supporters and anyone who cares about the cultural identity of Guelph.



Friends Website 2.0

The Friends website [<http://www.friendsguelphlibrary.ca>] is an important medium of communication that helps to keep its members and the citizens of Guelph up-to-date with news and information about upcoming events.

The current incarnation of the website provides information on past and future events. Visitors can access copies of the Friends' constitution, membership forms and its recent newsletters.

The future of the website will see its reorganisation and expansion by Ian Robson, a Library and Information Science postgraduate student who is volunteering with the Friends. His plan is to consolidate and reorganise the current site and to add more content that will be of interest to the users of the website. Some things that he would like to add to the site include:

- Biographical information about the Friends' Executive;
- News regarding the new main library
- News and information about other Friends groups throughout Ontario, the rest of Canada and beyond; and
- Links to various sites related to public libraries.

Ian welcomes questions and comments about the Friends website and may be reached at w.ian.robson@gmail.com

**Important
DATE!**

A New Benefit for Members of the Friends of the Library

One of the fringe benefits of membership in the Friends of the Guelph Public Library is preferred access to a newly-developed speakers' series which promises to be both interesting and fun. Admission to these events is free of charge; however tickets are required to allow control of numbers since seating is extremely limited. Members of the Friends have exclusive access until a few days before each event.

- Tuesday, March 3.

The first evening took place at the Westminster Branch when an enthusiastic audience heard, met and chatted with Guelph's own Giller Prize short-list nominee, Mary Swan.

Upcoming Author Evenings

- Tuesday, May 5,

Mike Cadman, co-ordinator of the Ontario Breeding-Bird Atlas for Environment Canada, will speak and show slides about the recently published second edition of the atlas. This breathtakingly beautiful book, five years in the development, uses more than 1000 volunteers to document about 400,000 bird-breeding locations. A comparison of new data with information in the original 1985 edition shows the impact of human activities such as mining, logging, urbanization and agriculture, on avian species.

It has been noted that the impact of environmental changes on birds predicts the impact of those same changes on a broad array of living things. Many species of birds are very sensitive to what most people would consider minor changes in habitat or climate. In light of on-going climate change, and ever-increasing urban sprawl, there is an obvious value in the tracking of changes in bird populations. The census and tracking research underlying this volume also help to identify threatened or endangered bird species.

The process of assembling this beautiful volume is amazing, and the information it contains is of enormous interest not only to birders, but also to environmentalists and to all informed and concerned citizens.

- September 2009 - April 2010

Look for 3 or 4 speakers per year, The first of the new year will be Guelph author Michelle Wan. Ms. Wan has written "Death in the Dordogne", a murder-mystery trilogy. The prolific and varied wild life, and particularly the wild orchids for which this area of France is famous, form the linking thread among the mysteries. This popular series published since 2005 has received excellent reviews; fans of the murder mystery genre will not want to miss this special evening.

An Evening with Mary Swan



Mary Swan, author of *The Boys in the Trees*, began by answering two of the most frequently asked questions: when did she know she wanted to be a writer, and what was the inspiration for *The Boys in the Trees*? She described herself as a child who was an avid reader, appreciative of the power of words and keen to express her thoughts until later, as an adult, her writing took the form of short stories.

The idea for *The Boys in the Trees* came to her on the basement floor of the University of Guelph Library. Surrounded by local history publications, she came across an account of a hanging in late 18th century Guelph. Initially, the *Boys in the Trees* was to be a short story but as the characters developed, the novel was formed.

Mary then read several pages of young Eaton's account of the hanging. Several audience members followed along from their own copies, and later posed questions ranging from the novel's authenticity and the process of writing to what's next? During the social hour following, Friends were able to speak individually with Mary Swan and have her autograph their copies of *The Boys in the Trees*.





**Online Assistance Now Available
to Library Patrons from 5 to 85**

The Guelph Public Library has offered *Live Homework Help* to Guelph students since 2006, and has recently extended this free service to early and adult learners. Adults have always come to the library for assistance with research and Adult Continuing Education support - as well as for help with resume or work-related writing. Now adults can connect online to a live expert either on library computers or from the privacy of home.

Every day from 4-10pm library members can log on to www.library.guelph.on.ca, and go to *Live Homework Help* to enter an Online Classroom where a certified subject expert will work with you in a chat window, on a drawing board, and through website and file sharing.

Students who have used the service are enthusiastic:

"This is a brilliant program, for people who are too timid to seek extra help."

"I would have given up on myself long before but somehow the tutor managed to get my brain to comprehend everything."

Book Sale News

3rd Annual Giant Book Sale, October 2009

You can Make it Happen!

In the past two years, the Friends of the Guelph Public Library have staged two enormously popular giant book sales, attracting 1000 visitors a day into the downtown core. From the beginning, the expectation arose that this would become an annual event, and the Friends are anxious to make it so. To do this, however, **WE NEED YOUR HELP!**

To justify the enormous amount of preparatory effort that goes into these events, and to do justice to the large number of quality items donated, the sale needs to last for more than one day. For 2009, Old Quebec Street has been reserved for October 23, 24 and 25. The plan is to have a private event on the Friday evening for volunteers and sponsors and to hold the public book sale for two days on the Saturday and Sunday.

To do this, we will need more volunteers at the time of the sale.

Financial sponsorships are needed to defray the unavoidable expenses, such as the cost of utilities in the space where donations are sorted, the cost of publicity, the cost of modest hospitality, and the cost of transportation to move donations to and from the sorting space. See page 5 for the sponsorship package which outlines both the needs and the benefits. Any donation of \$100 or more in support of the sale will be considered a sponsorship, and sponsors' names will be publicized unless anonymity is requested. *If you are connected to an individual or business who might participate in sponsorship of this event, please share this information with them and facilitate an introduction for us.*

The most crucial need, other than people, is for adequate storage/sorting space. A minimum of 1500 square feet of dry, heated space, suitable for occupancy by volunteer sorters as well as for the storage of donated materials, is crucial to the success of the sale. We need this space immediately and continuing until at least November 1. Space that might be available to us for two or more years would be even better. Such space must be rent-free. In the past, the Friends have paid for the utilities. *If you are aware of a sizeable, unused space suitable for this purpose, we would appreciate your assistance in establishing a contact.*

Finally, we need at least two more **key** volunteers. The book sale organizational team consists of the Chair, the Publicity Chair, a coordinator of the moving of donated books, and two small teams of individuals to organize and coordinate the sorting and the sale sites respectively. One of the members from each of the organizational teams has indicated that she cannot be involved at the same level in 2009. These two volunteer vacancies **must** be filled if the sale is to go forward. Please give this need serious thought, and approach anyone else you know who might be a possible volunteer.

In summary; for a 2009 giant book sale to become a reality, the following things are essential:



- A minimum of 1500 square feet of clean, dry, heated space for the period March to November.
- A minimum of two, new, key volunteers to be involved in the organization of the sale over an extended, preparatory period.
- Financial and in-kind sponsorship assistance.

The 2009 sale cannot happen if these needs are not met. Please volunteer, and facilitate our introduction to others who can help.

For further information, contact Virginia Gillham, virginiagillham@aol.com, 519-821-5874

2009 Book Sale Sponsorship Opportunities

Tax receipts are available for any donation of \$10 or more in support of the expenses related to mounting the book sale. **Any donation of \$100 or more, or in-kind donations of services or equipment with a value of \$100 or more, will be considered a sponsorship.**

Sponsorship Benefits:

- Tax receipt for the value of the donation
- Public recognition in advance publicity and at the time of the sale
- Invitation to the Friday evening sale preview
- Invitation to the post-sale volunteer recognition event
- Invitations to Friends of the Library special events throughout the year

Sponsorship Opportunities

Printing and advertising	\$ 800
Table and equipment rental	\$ 500
Transportation costs for the movement of donated books to the sorting space and to the final sale site. (Courier costs for delivery to the sorting facility @ \$75/week)	\$2,000
Sorting facility utilities	\$ 500
Post-event waste disposal	\$ 200
Hospitality for volunteers during and after the book sale	\$ 500

Donations of \$100 or more, and in-kind donations of services or equipment with a value of \$100 or more, as partial support of any specific cost are considered sponsorships and are gratefully received.

♪ Thank you, Volunteers ♪

Volunteers who assisted with our 1st and 2nd Giant Book Sales were invited to a "Thank You" evening at the Westminster Square branch on Wednesday, February 4.

Virginia Gillham welcomed everyone and thanked all present for their contribution to the success of both events. She announced that proceeds from the November sale, \$12,000, are invested with the Guelph Community Foundation until the construction of the new Main Library. The 2009 sale will take place over three days in October – but **only** if suitable storage space can be found. She encouraged all present to assist in this search.

Mary Mulholland then introduced Guelph's own James Gordon, "Guelph's Poet Laureate", who entertained with selections from *The Highway and I*, an audio book of songs and stories from 30 years on the road. His accounts of small town dinners, a booking in a "nature park", performing in competition with a noisy waterfall and the unsolved theft of his recordings intended for sale brought laughter and many knowing smiles. James was thanked by Virginia, and noted that copies of his CDs were available for purchase.

Mary outlined the new Speaker Series to be presented by the Friends; tickets were available for the March 3rd event with author Mary Swan. Audience members were also able to renew or purchase Friends memberships. A social hour with light refreshments concluded the evening.



GUELPH PUBLIC LIBRARY

100 Norfolk Street
 Guelph, Ontario
 N1H 4J6
 Phone: 519-824-6220
 Website: www.library.guelph.on.ca

Mr. Dewey and Friends,

the newsletter of the Friends of the Guelph Public Library, is published three times annually: spring, fall and winter. Next issue: June 2009.

Submissions, photos and comments are welcome. They may be delivered to the Friends mailbox at the Main Branch or to any Branch Library.

Website:
 www.friendsguelphlibrary.ca

Newsletter Editors
 Susan Ratcliffe, Marilyn Crooks

Checking out the Scottsdale Centre Branch ...

The Scottsdale Centre Branch is a bit like the *Little Engine That Could*. It is one of the smallest library branches (3500 sq. ft.) and the busiest. Here are a few 2008 statistics about Scottsdale Centre Branch:



- We checked out 300,138 items (+3.83% over 2007)
- We check out an average of 895 items daily
- We filled 40,284 reserves (books on hold) during 2008
- We have 19,980 members
- We have over 40,000 items to be borrowed
- We hold weekly children's programs



The circulation staff at Scottsdale is knowledgeable and experienced (all hold between 4 and 20 years of service with the library). In fact, the staff is such a fountain of knowledge, experience and helpfulness that they have been asked for help in every area of expertise over the years. Here are a few examples:

- ? "Do you have the movie with a picture of two men wearing black hats?"
- ? "Where can I get replacement heads for my Braun electric toothbrush?"
- ? "Where can I buy a swim cap?"
- ? "Can someone help me check the air pressure in my tires...my car is just outside?"
- ? "How do I get rid of my tenant's bedbugs?"

And finally ... "Does your staff have training for psychological issues?"
(The answer is "Yes"!)

Why become a Friend of the Guelph Public Library? Friends have the opportunity to

- meet and join an enthusiastic group of people dedicated to furthering the purposes of the Library
- participate in the programs and activities which are offered by the Friends of the Guelph Public Library
- enjoy the satisfaction which comes from serving your community

Friends of the Guelph Public Library

2009 MEMBERSHIP APPLICATION

Enclosed is my/our annual membership fee and/or donation.

Renewal New

\$10 Individual Friend \$5 Senior (65+) /Student

\$15 Family (list dependent children)

\$30 Community Group \$50 Corporate

Name: _____

Address: _____ City: _____

Postal Code: _____ Day Phone: (____) - ____ - _____ Evening Phone: (____) - ____ - _____

Email: _____ Enclosed: Cash Cheque (payable to Friends of the Guelph Public Library)

My/our areas of interest are: Program Fundraising Publicity Newsletter Advocacy Book Clubs

Literacy Issues Author Visits Writing/Reading Workshops Educational Exhibits Special Events

Membership Hospitality Other (please specify) _____